

**FLOOR STRUCTURE COMPONENTS with BOLT ANCHORS
USING GS22 or GS26 RF SHIELDED PANELS with Corner Flashing**

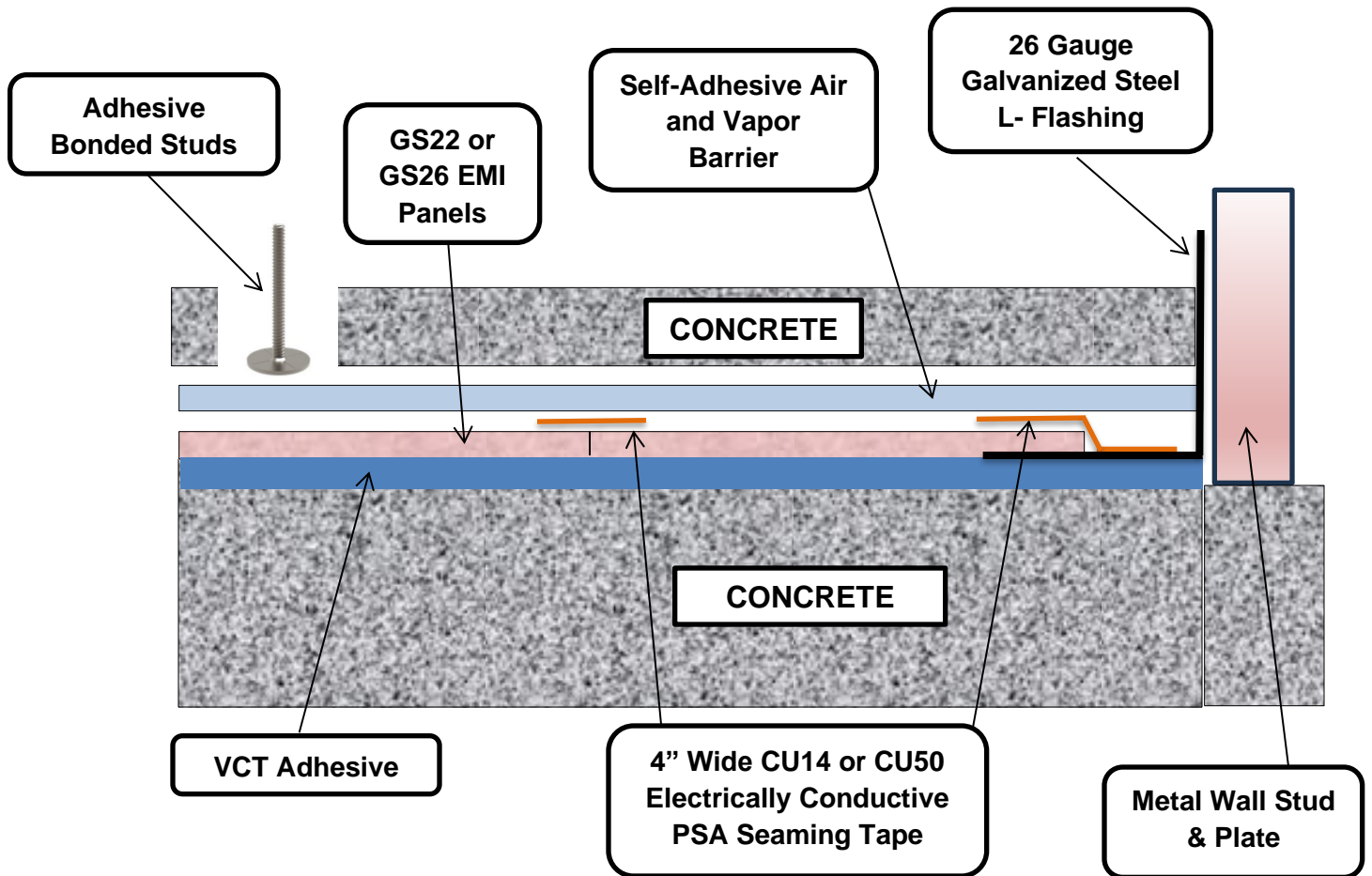

**4" x 4" or 6" x 6" 26 Gauge Galvanized Steel L-Flashing is Typical
Wall Shielding Attaches to the Vertical Portion of the Flashing**

**IDEAL RF SHIELDED FLOOR SYSTEM FOR
COMPUTER DATA CENTERS
60Db TO 100Db**

**GS22 or GS26 Panels Can be Butt Jointed or Overlapped
and Seam Taped with CU14 or CU50 ECPSA Foil Tape
Depending on the Shielding Effectiveness Required**