

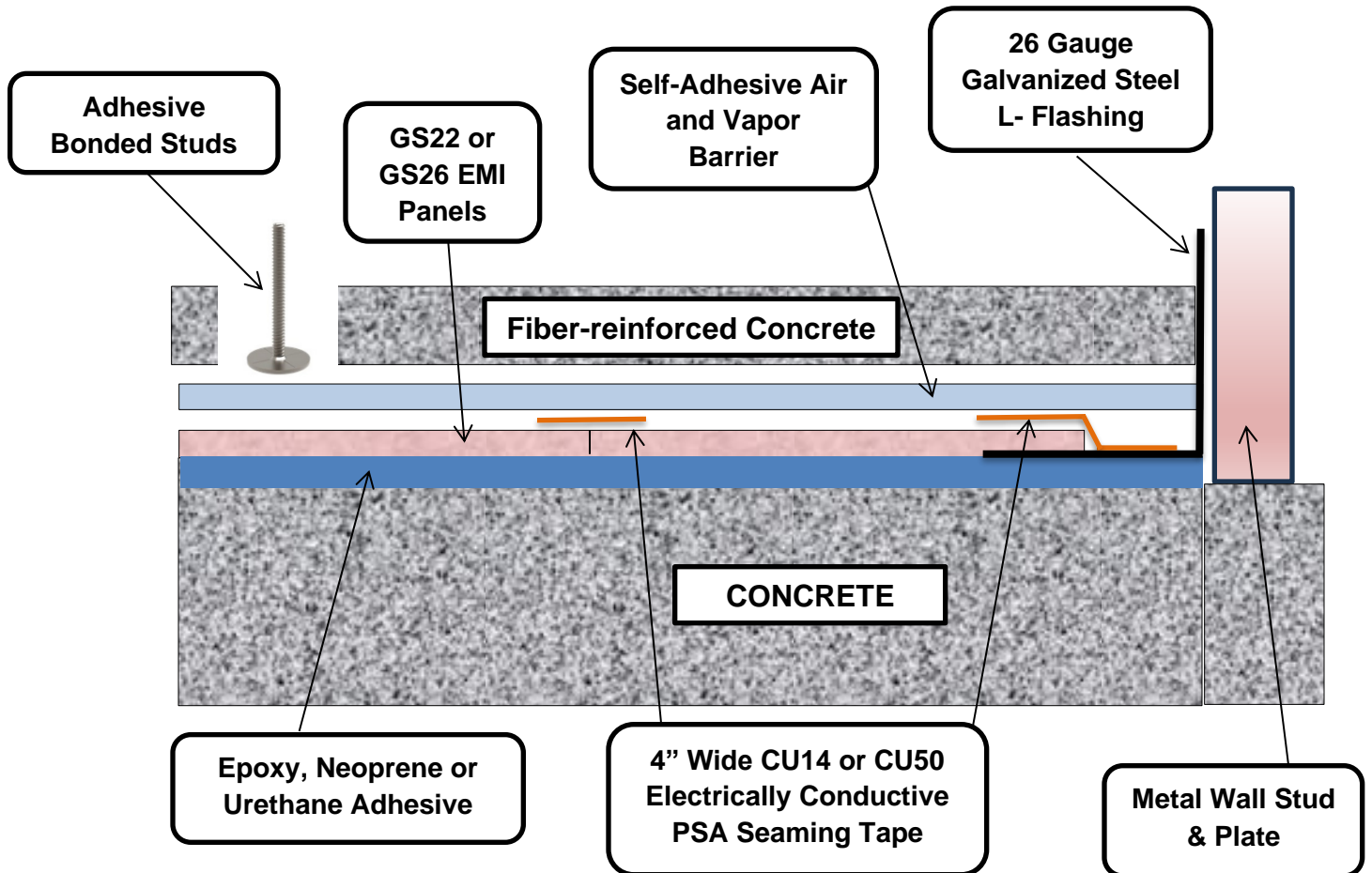

FLOOR STRUCTURE COMPONENTS with BOLT ANCHORS
USING GS22 or GS26 RF SHIELDED PANELS with Corner Flashing



4" x 4" or 6" x 6" 26 Gauge Galvanized Steel L-Flashing is Typical Wall Shielding Attaches to the Vertical Portion of the Flashing

IDEAL RF SHIELDED FLOOR SYSTEM FOR COMPUTER DATA CENTERS
60Db TO 100Db

GS22 or GS26 Panels Can be Butt Jointed or Overlapped and Seam Taped with CU14 or CU50 ECPSA Foil Tape Depending on the Shielding Effectiveness Required